



**Hucclecote Road, Hucclecote, Gloucester GL3 3SH**

**£55,000** Leasehold



**MICHAEL TUCK**

The Agent with 5 star customer service



**Flat 9 Hucclecote Lodge, Hucclecote  
Road, Gloucester, Gloucestershire, GL3  
3SH**

**£55,000**

Leasehold. Council Tax Band A



**1 Bedrooms**



**1 Bathrooms**



**1 Receptions**

**Features**

- \* 1 BED GROUND FLOOR APARTMENT
- \* OVER 60's RETIREMENT COMPLEX
- \* WARDEN CONTROLLED
- \* CHAIN-FREE
- \* ATTRACTIVE COMMUNAL GARDENS
- \* GREAT ACCESS LINKS
- \* OFF-ROAD PARKING
- \* EPC C, Council Tax Band A

**Michael Tuck Estate and Letting Agents**

2 Mead Road Abbeymead Gloucester Gloucestershire GL4 5GL

01452 612020

[estates.abbeymead@michaeltuck.co.uk](mailto:estates.abbeymead@michaeltuck.co.uk)

[www.michaeltuck.co.uk](http://www.michaeltuck.co.uk)

**The Property**

\*\* 1 BED GROUND FLOOR APARTMENT, OVER 60'S WARDEN CONTROLLED COMPLEX, CHAIN-FREE \*\* MICHAEL TUCK ESTATE AGENTS are pleased to welcome to the open market this chain-free, 1 bedroom ground floor apartment, located within the very sought after Hucclecote Lodge. The apartment is located to the rear of the complex and looks over the lovingly maintained gardens. Accommodation briefly consists of; Entrance hall, lounge, kitchen area, bedroom and shower room. Hucclecote Lodge also benefits from being warden-controlled and offers further communal socialising areas. Outside can be found well-tended communal gardens and off road parking. Call us today on 01452 612020 to book your viewing. Offered For Sale by Michael Tuck Estate Agents, Abbeymead, Gloucester.

**Entrance Hall**

**Lounge** 13' 10" x 11' 0" (4.22m x 3.36m)

**Kitchen** 8' 11" x 5' 6" (2.72m x 1.68m)

**Bedroom** 11' 1" x 9' 11" (3.37m x 3.02m)

**Shower Room**

**Charges**

Ground Rent £25 Service Charge £1450 per annum (covers insurance, maintenance, warden)  
Lease expires 31/10/2083











## GROUND FLOOR

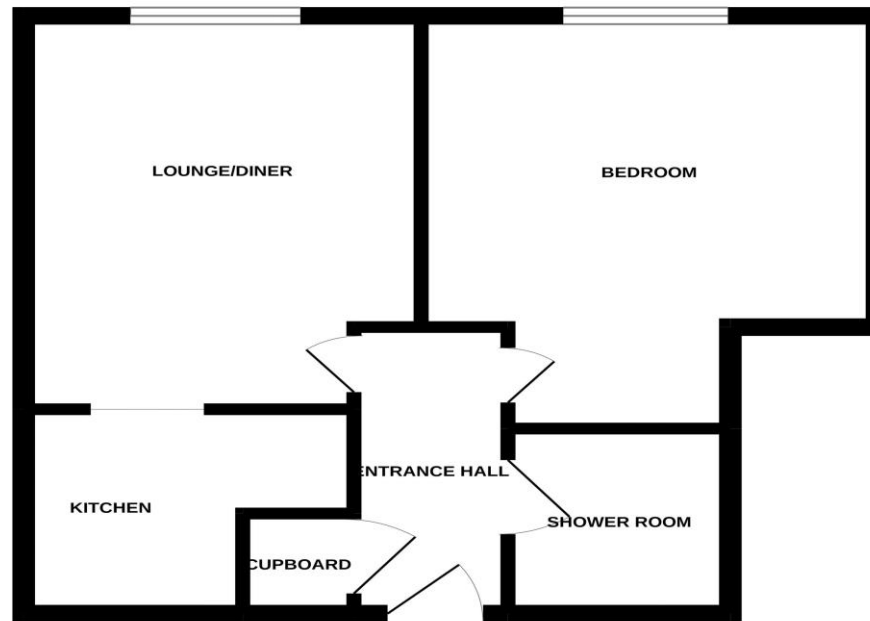

Whilst every attempt has been made to ensure the accuracy of the floorplan contained here, measurements of doors, windows, rooms and any other items are approximate and no responsibility is taken for any error, omission or mis-statement. This plan is for illustrative purposes only and should be used as such by any prospective purchaser. The services, systems and appliances shown have not been tested and no guarantee as to their operability or efficiency can be given.  
Made with Metropix ©2022

### FOR ILLUSTRATIVE PURPOSES ONLY – NOT TO SCALE

The position and size of doors, windows, appliances, and other features are approximate only.  
Unauthorised reproduction prohibited

**Important notice:** Michael Tuck, its clients and any joints give notice that 1: They are not authorised to make or give any representations or warranties in relation to the property either here or elsewhere, either on their own behalf of their client or otherwise. They assume no responsibility for any statement that may be made in these particulars. These particulars do not form part of any offer or contract and must not be relied upon as statements or representation of fact. 2: Any areas, measurements or distances are approximate. The text, photographs and plans are for guidance only and are not necessarily comprehensive. It should not be assumed that the property has all necessary planning, building regulation or other consents and Michael Tuck have not tested any services, equipment or facilities. Purchasers must satisfy themselves by inspection or otherwise.

